

# BHU-02

## Automatic PCB Unloading System

UNLOADER

### Functional Description

- Unloading PCB's from a module into a magazine
- Manual magazine exchange
- Infeed track with pusher
- Individually controlled by P.L.C.
- Magazines with var. dimensions applicable
- Operation function keys by terminal display
- Communication via SMEMA standard
- Tower Light
- Pre-alarm



### Module Specifications

Loader LxWxH	1137x941x1462 mm
Transport Height	930mm +35/-25mm
Transport Width	50 – 460 mm
Transport Speed	15 m/min
Cycle time	>10 sec./board
Transport direction	Left to Right
Fixed rail	Front, facing from operator
Selectable pitch	A multiple of slots min. pitch distance 10 mm
SMEMA	Included
Control	OMRON
Motor control	Motor Control Board
Operation	By terminal display
Software	Syswin
Colour	Ral 9002
Power consumption	375 Watt
Power requirements	230V, 50Hz, single phase with ground or 110V, 60Hz
Compressed air	6 bar, dry, clean, non- lubricated air 0.5 Nm <sup>3</sup> /h
Cables & wiring	According NEN-EN 60204-1
Weight	175 kg

### Options

<b>BHR-701-3:</b>	
Magazine footprint LxWxH	355x320x563 mm
PCB Width	40 to 250 mm
PCB Length	50 to 342 mm
<b>BHR-704-3:</b>	
Magazine footprint LxWxH	460x400x563 mm
PCB Width	40 to 330 mm
PCB Length	50 to 447 mm
<b>BHR-706-3:</b>	
Magazine footprint LxWxH	535x460x570 mm
PCB Width	40 to 390 mm
PCB Length	50 to 522 mm

### Required Options

<b>BH-EU:</b>	
Supply Voltage	EU 230 V AC
<b>BH-US:</b>	
Supply Voltage	US 115 V AC

(for more detailed information, please check the specific datasheet)

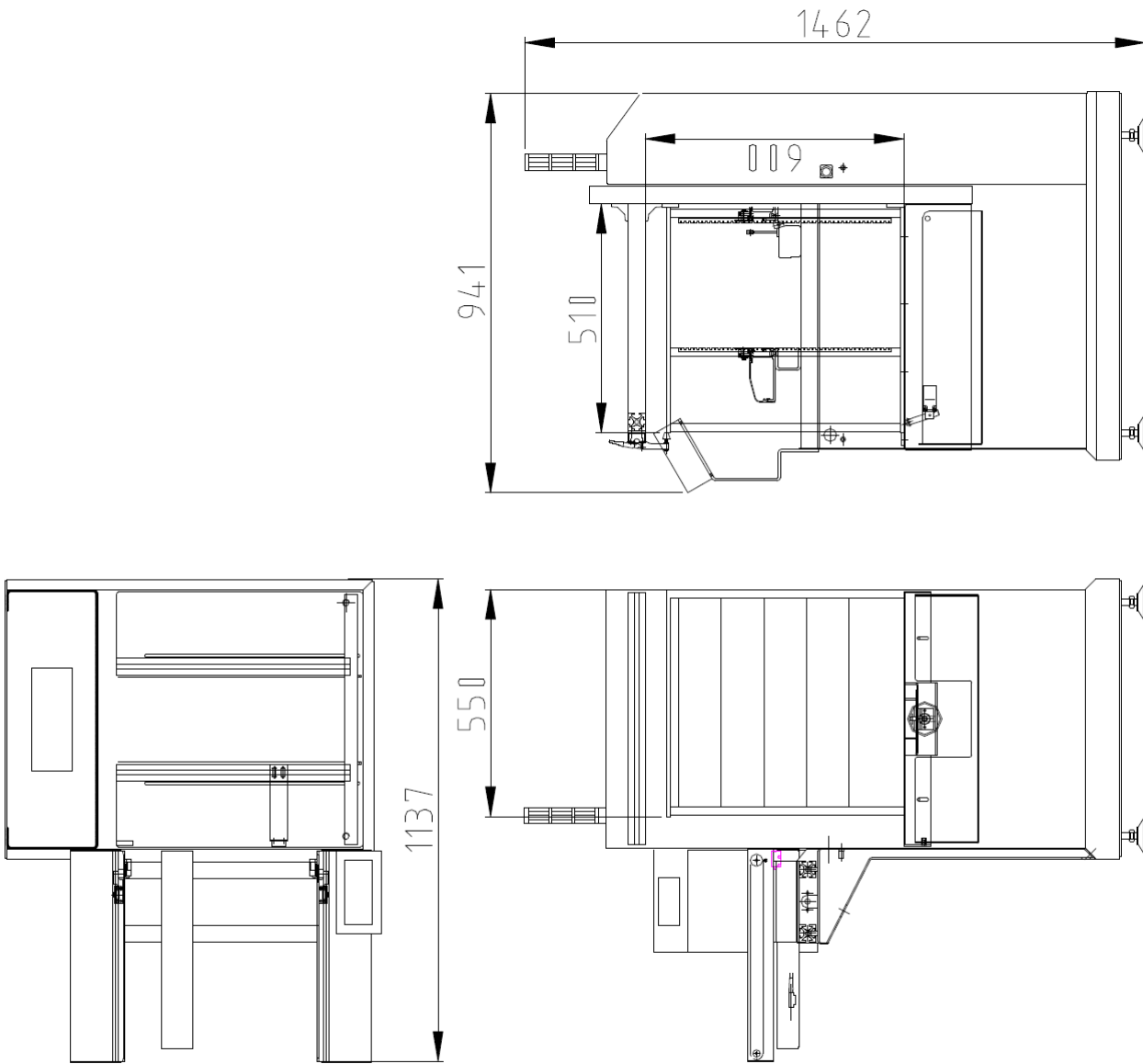

Board Handling